



00
+
H
H

SPIRIT OF WATER



HYLAS
SAILING YACHTS





HYLAS OVERVIEW

Hylas Yachts are built by Queen Long Marine, a third-generation family-owned yacht builder. Queen Long's collaboration with globally recognized designers - German Frers (Argentina), Bill Dixon (UK) and Sparkman and Stephens (USA) has established them as a preeminent brand in sail and power across multiple geographic and lifestyle markets.

Hylas Yachts International and Queen Long Marine ensures we have control from design to delivery and beyond. Every step of the process is focused on quality and service. Every department recognizes that our success can only come from delivering a product and support that our clients will want to share with others as their dreams take them across oceans in safety and style.



HISTORY OF HYLAS YACHTS

The Hylas brand was established in 1985 by Queen Long Marine who's shipyard was founded in 1978 by the Huang family and remains in full family operation and ownership to this day. The 117,300 sq ft shipyard is home to a 32,000 sq ft main construction hall, dedicated 18,000 sq ft laminating hall, a large paint facility, extensive design and administration offices and their famous on-site 3m-deep full-sized yacht testing tank complete with a thriving population of ornamental Koi Carp. Some 76 shipwrights, laminators, engineers, electricians and painters are employed directly by the shipyard to build the Hylas range of motor and sailing yachts. Of which over 500 have been launched to date. The Taiwan based team have an impeccable reputation for hosting our clients. We very much encourage visits during the build process.



PERFORMANCE

The Hylas H48 is a perfect marriage of pedigree craftsmanship & bluewater capability. Wide, clean decks, a self-tacking staysail for ease of handling, wrap around deck-salon windows for optimum light and visibility and a spacious center cockpit. 3-cabin, 2-heads. "The H48 uses some elements from the proven quiver of Hylas attributes, including true oceangoing capability, the center cockpit, the large windows, and the swim platform steps," Dixon says. "But this model changes the flow on board, whether the owners and guests are moving about the spacious decks or relaxing together in the bright salon, making the most of the onboard volume while factoring in the need for human-size spaces."



- ≈ Spacious center cockpit
- ≈ Large master stateroom aft for comfort and maximum living space with plenty of headroom
- ≈ Walk through galley with space for a number of home comfort appliances and plenty of engine access

- ≈ Self tacking staysail
- ≈ Electric in mast furling
- ≈ Genoa furlex electric furler
- ≈ Swim steps for easy boarding and relaxing





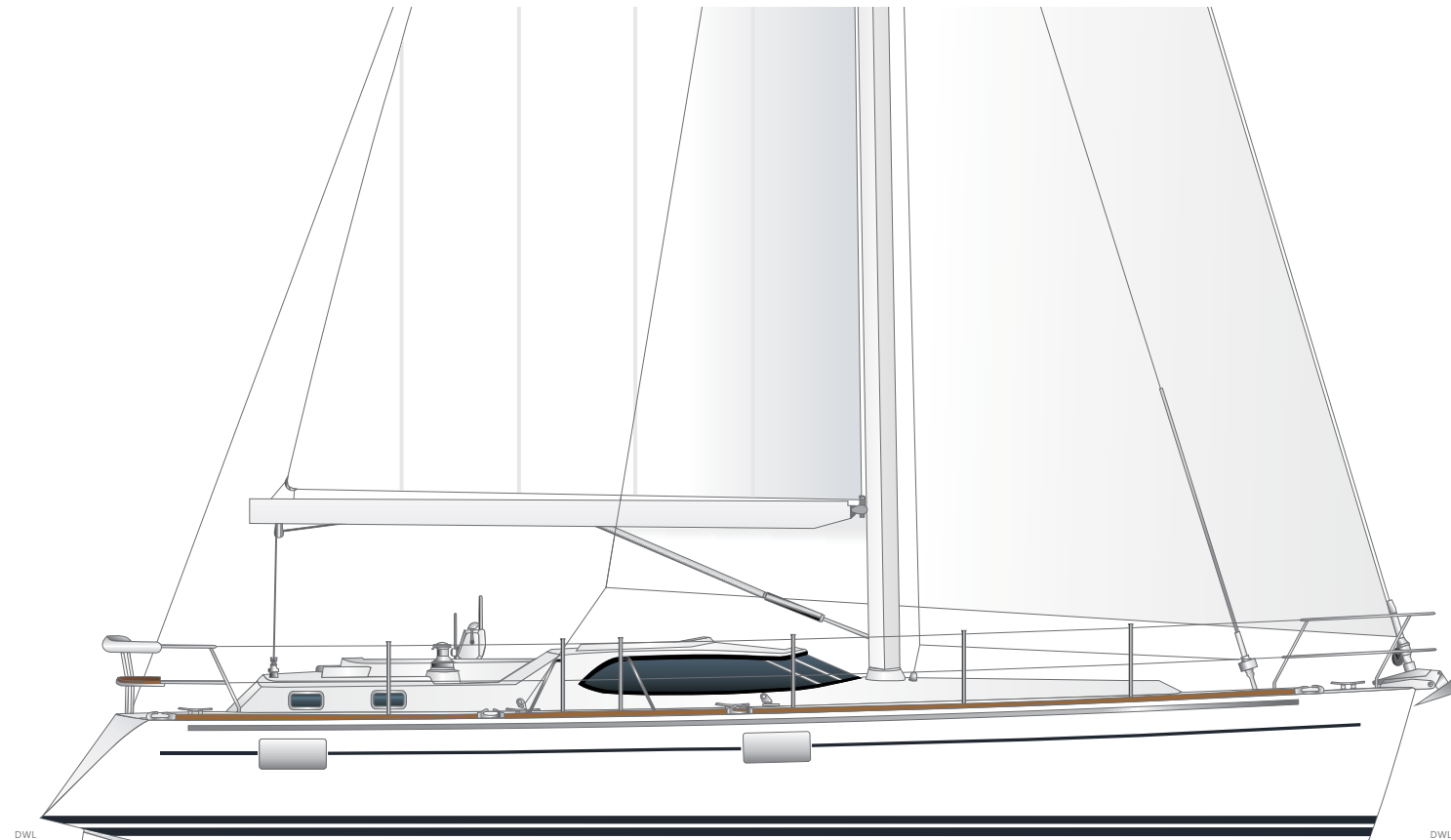
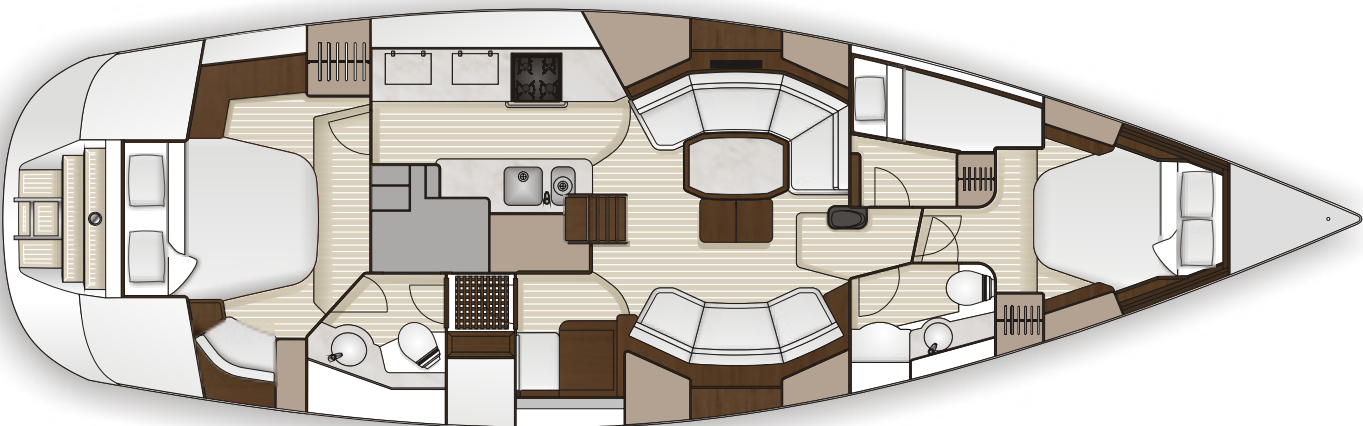
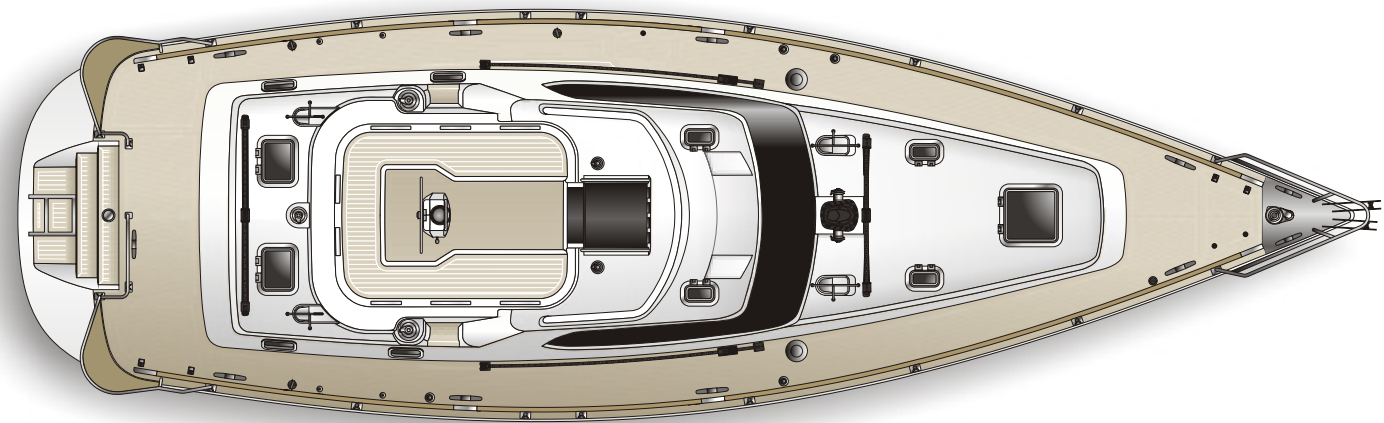

SPECIFICATIONS

LENGTH OVERALL	48'0" 14.63 m
LENGTH OF WATERLINE	42'0" 12.80 m
BEAM	14'6" 4.42 m
DRAFT	6'6" 1.98 m
DISPLACEMENT	42,000 lbs 19,051 kg
WATER TANKAGE	119 gal 451 litres
FUEL TANKAGE	290 gal 1,100 litres
ENGINE	Yanmar 75 hp
CE	Category A Ocean
DESIGNER	Bill Dixon

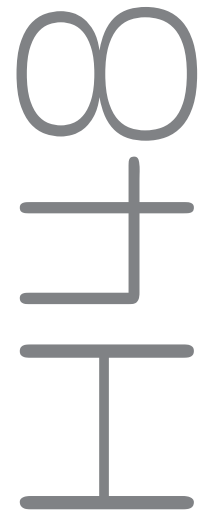



H48

HEADQUARTERS | QUEEN LONG MARINE | TAIWAN | +886 7 831 5216 | QLMARINE@HYLASYACHTS.COM.TW

US SALES OFFICE | HYLAS YACHTS | WEST PALM BEACH FL | +1 561 515 6027 | INFO@HYLASYACHTS.COM

UK SALES OFFICE | LONDON UK | +44(0)1590 673715 | ENQUIRIES@HYLASYACHTS.CO.UK

ITALY SALES OFFICE | FLORENCE ITALIA | +39 333 74 89 281 | INFO@HYLASYACHTS.IT

HYLASYACHTS.COM

Hylas
Yachts