

GENERAL SPECIFICATIONS

• Overall Length (L.O.A):	14,78 m	48'6"
• Hull length:	13,50 m	44'3"
• Overall width:	4,20 m	13'9"
• Hull Beam:	4,15 m	13'7"
• Light displacement (EC):	11 241 kg	24,782 lbs
• Air draft*:	4,59 m	15'
• Draft:	1,20 m	3'9"
• Fuel tank capacity:	2 x 450 L	2 x 119 US Gal
• Fresh water capacity:	2 x 200 L	2 x 53 US Gal
• Maximum engine power:	2 x 328 kW - 2 x 440 HP	2 x 440 HP
• Max engine certification:	2 x 328 kW - 2 x 440 HP	2 x 440 HP

* (included: Radar support)

ARCHITECTS / DESIGNERS

- Naval Architect: Beneteau Power Boats & MICAD
- Design: Andreani Design

EC CERTIFICATION

- Category B - 12 people
- Category C - 12 people

AIR STEP SYSTEM®

- R.L. Jeantet
- P. Tableau
- M. Tronquez

2 cabin layout

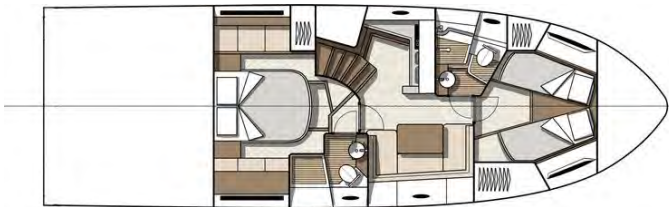

3 cabin layout

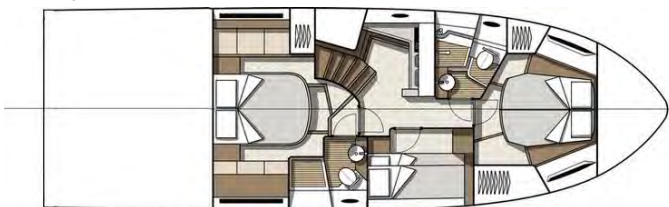

seanapps

CONNECT YOUR BOAT FREE YOUR MIND

STANDARD EQUIPMENT

CONSTRUCTION

HULL

- Air Step system®
- White hull
- Composition:
 - Sandwich (polyester resin - fiberglass - balsa core)
 - Hull counter molding laminated in monolithic (polyester resin - fiberglass)
- 8 Opening portholes

DECK

- Composition:
 - Sandwich (polyester resin - fiberglass - balsa core)
 - Deck counter molding laminated in monolithic (polyester resin - fiberglass)

DECK EQUIPMENT

- Courtesy light in cockpit
- Navigation lights

MOORING - ANCHORING GEAR

- Bow fitting with anchor securing system
- 1 000 W Electric windlass (with remote control)
- 2 Forward cleats, 2 central and 2 aft in stainless steel

SAFETY ON DECK

- Half open pulpit in stainless steel with guardrail and handrail
- 2 Stainless steel handrails on access to sidedeck steps

COCKPIT

- Self-bailing cockpit
- Access through a gate with safety catch
- Cockpit windows
- 8 People salon
- Solid wood cockpit table
- 4 Storage lockers (under the seats)
- Cockpit galley with sink, foldaway tap, Storage & Garbage bin
- Engine access hatch
- Space for cased life raft
- Cockpit shower with mixer tap
- Swim platform (3,62 x 1,33 m / 11'11" x 4'4") + Swim ladder
- Hand rail on rear table
- Assorted exterior upholstery:
 - Marlin Auster (standard)
 - Dolce 80
 - Vita 16
- Sun deck
- Tender garage:
 - Dinghy (230 cm / 9')
 - Electrically-opened, using 2 electric struts
 - Access to engine room by the garage
- Aft galley featuring BBQ grill (Option)
- Pre-wiring for 40" TV (115 V 60 Hz + RA670)
- Audio Pack Fusion: Fusion RA210 + 2 Speakers
- Cockpit windows with opening portholes to port and starboard

STEERING STATION

- Polyester, Steering station to starboard
- Pilot seat with function Bolster
- Double bench seat with Bolster option (Co-pilot)
- Foldable footrest
- Pilot and co-pilot upholstery matching the cockpit salon upholstery
- 2 Handrails
- Gloss black dashboard with grey padded cover
- Volvo 4" screen
- Space for electronics (12" or 16")
- Polyester hard-top with built-in electric sunroof
- Glass windscreen with 2 fitted electric wipers
- Anti-glare surface in grained polyester under windscreen
- 4 Cup holders

INTERIOR

- 3 gloss Alpi grey walnut woodwork
- Brown oak laminated floors
- Direct and indirect LED lighting

GALLEY

Headroom: 1,95 m / 6'5"

- Double stainless steel sink, with mixer
- Microwave oven (115 V - 60 Hz)
- Ceramic hob (115 V - 60 Hz)
- White corian type countertop
- 218 L Fridge Freezer
- Covered stowage drawer
- Garbage bin
- Units with white
- 4 Storage cupboards
- 1 Hull window with built-in opening porthole
- Venetian blinds
- 2 115 V Power outlets
- Leather covered handrails

SALON (2 cabin layout only)

Headroom: 1,99 m / 6'6"

- Sofa seating for 4, upholstery Talisman Chinchilla fabric (standard)
- Wooden table, grey walnut - Stainless steel foot
- TV Pre-wiring - 24" max (Amplifier Fusion RA670 + Fusion 6" Loudspeakers + TV mounting)
- 4 Storage cupboards
- 2 Storage lockers (under the seats)
- 2 Skylights
- 1 Hull window with built-in opening porthole
- Venetian blinds
- 1 115 V Power outlet
- Direct and indirect LED

GUEST CABIN (3 cabin layout only)

Headroom: 1,99 m / 6'6"

- 2 Bunk beds (0,52 x 1,97 m / 1'8" x 6'6")
- 2 Reading lights
- 1 Bed side table with drawer
- 1 Hanging locker
- 1 Hull window with built-in opening porthole
- Venetian blinds
- 1 115 V Power outlet
- Direct and indirect LED

VIP CABIN (FORWARD)

Headroom: 1,94 m / 6'4"

- 1 double bed (1,57 x 1,92 m / 5'2" x 6'4") or 2 single beds (sliding system)
- Marine mattress
- Slatted bed base
- 2 Reading lights
- 2 Shelving unit
- 2 Hanging lockers
- 1 Cupboard with shelves
- 1 115 V Power outlet
- TV Pre-wiring (Amplifier Fusion RA670 + Fusion 6" Loudspeakers + TV mounting)
- 2 Panoramic windows with opening ports and blinds
- Venetian blinds
- Opening deck hatch with mosquito screen/blind
- Direct and indirect LED

VIP HEAD COMPARTMENT (FORWARD)

Headroom: 1,95 m / 6'5"

- Sink with mixer tap
- Mirror
- 2 Storage cupboards
- 1 Opening porthole
- Venetian blinds
- Shower separated by translucent door
- Electric toilet Quiet Flush
- Slatted floor
- 2 115 V Power outlets

OWNER'S CABIN (AFT)

Headroom: 1,93 m / 6'4"

- Double berth (1,50 x 1,99 m / 4'11" x 6'6")
- Marine mattress
- Slatted bed base
- Padded headboard with indirect lighting
- 3 Storage lockers
- 1 Hanging locker
- Pre-wiring for 22" TV (Amplifier Fusion RA670 + Fusion 6" Loudspeakers + TV mounting)
- 2 115 V Power outlets
- 2 Panoramic windows with opening ports and blinds
- Venetian blinds
- 1 Light well with shutter

OWNER'S HEAD COMPARTMENT (AFT)

Headroom: 1,98 m / 6'6"

- Sink with mixer tap
- Mirror
- 3 Storage cupboards
- 1 Opening porthole
- Venetian blinds
- Shower separated by translucent door
- Electric toilet Quiet Flush
- Slatted floor
- 1 115 V Power outlet

ENGINE

- Propulsion Z-drive or IPS
 - Choice between:
 - Volvo Diesel IPS 600 engine 2 x 440 HP
 - Volvo Diesel Z-drive engine 2 x D6 380 HP + Joystick
 - Throttle & controls
 - Neutral (Activation of neutral)
 - Station (Activation of the station)
 - Trim (Trim adjustment - only on Z-drive versions)
 - Docking Joystick
 - Fuel filter with decanter
 - Sea water filter
 - Air intakes on the deck for engine compartment cooling
 - Engine room foam soundproofed
 - Fire extinguishing system activated from the steering station
 - Stainless steel fuel fill
 - 2 x 450 L / 119 US Gal Aluminum fuel tanks
- Steering system:
- Electric steering
 - 2 Bases or Pods with counter-rotating propellers
 - Electrical engine controls
 - Volvo IPS:
 - Trip computer
 - Cruise control
 - Single lever
 - Low speed
 - Volvo Z-Drive:
 - Trip computer
 - Cruise control
 - Tow mode
 - Single lever
 - Power trim assistant

ELECTRICITY

- 2 engine batteries (12 V - 115 Amp) + 3 service batteries (12 V - 115 Amp) + Electrical gauge
- 1 Extinguisher
- Load balancer
- Battery charger (12 V - 40 Amp)
- Antenna pre-wiring
- Interior power outlet 115 V
- Shore power socket (115 V - 32 A)
- Roller for shore power lead (115 V - 60 Hz)
- 7 kVA Generator (115 V - 60 Hz)
- Spotlights and LED reading lights

PLUMBING

- 2 Rotomolded water tanks, capacity of 200 L / 53 US Gal each + Electrical gauge
- Stainless steel water fill
- Water pump for pressurizing hot/cold water system
- Shore freshwater supply
- 40 L / 11 US Gal Water heater working off engine exchanger and 115 V
- 2 Bilge pumps:
 - 2 Electric bilge pumps (50 L/minute)
 - 1 Manual bilge pump (30 L/minute)
- 120 L / 32 US Gal Rigid holding tank

SMART BOARD

"SEANAPPS" smart technology:

- For monitoring the boat's status and receiving alerts as well as maintenance advice via the associated mobile applicatio.
- The type of information collected (GPS position, batteries, engine info, navigation data, etc.) varies according to the boat's configuration.

seanapps

CONNECT YOUR BOAT FREE YOUR MIND

MISCELLANEOUS ITEMS

- Smoke detector

TRIM LEVEL & PACKS

CONFORT TRIM PACKAGE

- Tender launching system (winch and rollers)
- 49 L Cockpit refrigerator
- Kenyon electric grill - 115 V - 60 Hz (Swim platform)
- Multifunction Garmin 12" screen
- Port and starboard sliding windows

PACKS

ELECTRONIC PACK

- Induction charging station (mobile telephone)
- Ship control (web server)
- Broadband 4G Garmin radar
- Multifunction Garmin 8416 screen + Depth sounder (replacing the 12")
- Garmin Autopilot
- 315i VHF + Garmin 800 AIS

PREMIUM FOREDECK PACK

- Forward sun deck: Retractable canopy
- Forward sun deck: cushion + Protective cover + 2 Cup holders (Upholstery depending on version)
- Forward sun deck: Courtesy lighting

SPORT CHIC PACK

- Glazed cockpit door + Aft electric bay window
- Steering wheel upgrade
- carbon fiber padding in cockpit
- Cockpit: LED strip
- Interior: White-laquer finished furniture

OPTIONS

INTERIOR LAYOUT / ONBOARD COMFORT

- Cockpit air conditioning (115 V - 50 Hz - 16 000 BTU)
- Salon and cabin air conditioning (115 V - 50 Hz - 24 000 BTU)
- Diesel heater "air pulse"
- Dishwasher for 6 sets
- 8 Salon upholstery:
 - Talisman Chincilla (standard)
 - Trailblazer 35 Cloud
 - Bora Bora 51
 - Marlin Auster
 - Ultra Leather Pelican
 - Foglizzo Duke 15 beige leather
 - Foglizzo Duke 17 grey leather
 - Foglizzo Duke 45 taupe leather
- Mosquito screens on portholes
- Starboard and portside window
- Sunroof glass + curtains
- Savage Abundance 31 carpet in salon and cabins
- Dune Berber carpet in salon and cabins
- Double berth in salon (2 cabin layout)
- Garmin Surround View Camera System

WATER SYSTEM

- Pump for deck washing

EXTERIOR OPTIONS

- Complete mooring/anchoring kit
- Integrated hydraulic gangway
- Hydraulic immersible swim platform (Maximum load: 350 kg / 771 lbs)
- Dinghy cradle integrated into swim platform
- Outside upholstery:
 - Marlin Auster (standard)
 - Dolce 80
 - Vita 16
- Sunworker Black exterior wheelhouse curtains
- Electric cockpit grill (Kenyon)
- Cockpit ice maker
- Aft cockpit cover basic
- Aft cockpit cover upgrade
- Black Sunworker sunshade for the cockpit
- Zaf Factor Luxe Cream cockpit carpet
- Protective covers exterior upholstery
- Grey blue and white hull
- Hull wrap

ELECTRICAL SYSTEM

- 12 V / 115 V inverter (700 VA)
- Battery switch remote control
- Underwater lights
- Deck searchlight
- Aft lighting in the Hard-Top

ENGINE

- Bow thruster
- Zipwake automatic trim system